

for
10ml
5ml
pipette

**No electric power
required at all!**

Repetitive Pipette

Peggy



Aspirate the sample all at once, dispensing its necessary volume repetitively.

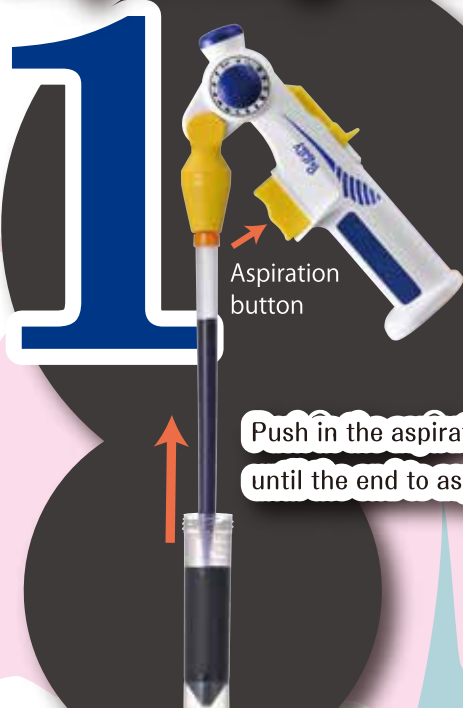

Push in the aspiration button once slowly until the end to aspirate the set volume.

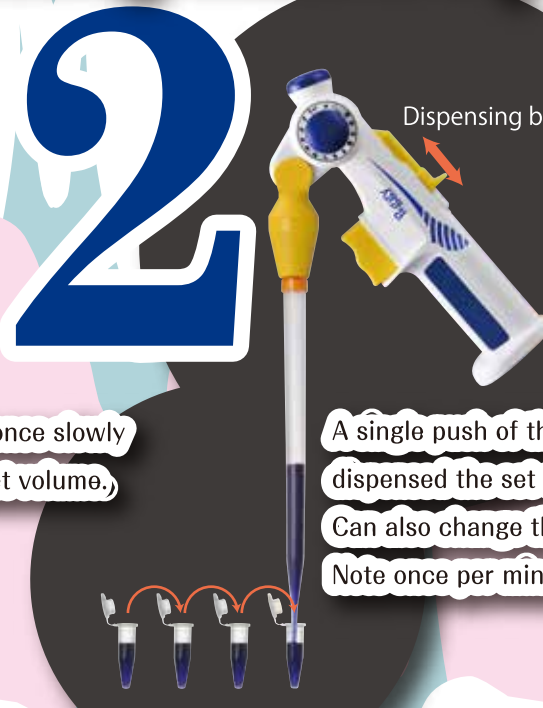

Dispensing button

A single push of the dispensing button dispensed the set volume.

Can also change the dispensing capacity Note once per minute.

Setting aspiration volume



Pull up and revolve

Aspiration can be set in every 1ml for setting range 1ml~13ml.

Note: 13ml can be dispensed in case that Watson 10ml Disposable Pipette is used.

Setting dispensing volume



Dispensing can be set in every 0.5ml for setting range 0.5ml~5ml.

Flexible nozzle-angle

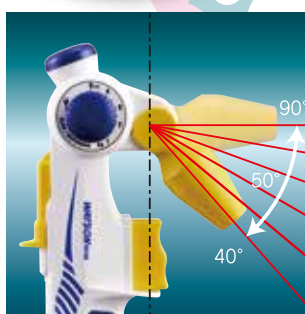

Adjustable nozzle angle in every 10 degrees up 50 degrees.

Simple maintenance

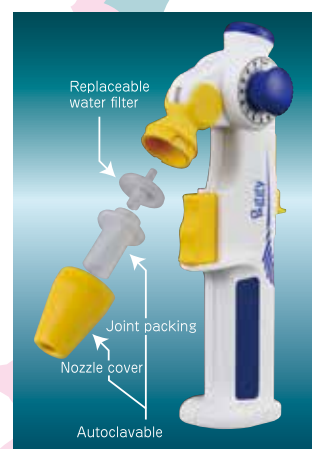

Easy to remove & set spare parts

- Nozzle cover: Autoclavable
- Joint packing: Autoclavable
- Water filter: Replaceable

Precaution in case of using 5ml disposable pipette:

Please DO NOT set aspiration volume exceeding 5ml in case that 5ml disposable pipette is used. It may cause an accidental liquid suction leading to malfunction on Peggy.

Cat.No.	Item	Aspiration Volume		Discharge Volume		Packaging
		max.	min.	max.	min.	
PG-01	PEGGY-01 Repetitive Pipette "Peggy"	13 ml	1 ml	5 ml	0.5 ml	1 pce./box

Something Different.

WATSON BIO LAB
MADE IN JAPAN SINCE 1988

<http://watsonbiolab.com>

Manufactured and sold by:

FUKAEKASEI CO., LTD.

Head Office: 2-2-7 Murotani, Nishi-ku, Kobe
651-2241, JAPAN
TEL +81-78-991-4477 FAX +81-78-991-4491

E-mail: info@watson.co.jp

※The specification and the price etc. of the product might change without a previous notice.